

Installing ULTRAFLEX 450

TIPS

- ULTRAFLEX 450 is **first aid** for damaged off-angle corners. Keep a roll on hand for fixing cracks, peels, chips and dents. NO-COAT's thin corner profile allows you to repair damaged drywall corners without a buildup of product.
- When installing ULTRAFLEX 450, preflex the material and run a pencil down the apex of the corner **for a clear reference point** (similar to a chalk line).
- If you are installing ULTRAFLEX 450 on a long span off-angle by yourself, you can use a tack pin to **hold it in place** before the mud sets. Then, remove the pins and adjust the corner as you wipe it down.

INSTALLATION INSTRUCTIONS

1. Open ULTRAFLEX 450 box and feed product through slot on side of box. Insert hook of tape measure into narrow slot to measure length of ULTRAFLEX needed. Cut to length with scissors.

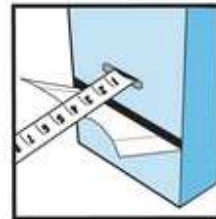

2. With 4-6" taping knife, apply All-Purpose drywall compound to corner and press ULTRAFLEX 450 into position. NOTE: The joint tape side (with the NO-COAT logo) of the corner goes against the drywall.



3. Remove excess mud with the same knife and let dry.

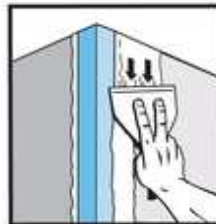

4. Use a 6"-8" finishing knife to skim over corner; let dry. Sand and finish.

