

PRELUDE® XL MAX™

Exposed Tee System

UP TO **25%** RECYCLED CONTENT
armstrong.com/greengenie

LEED®

- construction waste mgmt.
- design for flexibility
- EPD
- recyclable/producer resp.
- recycled content
- sourcing of raw materials



Prelude XL Max with Ultima item 1935 ceiling panels

KEY SELECTION ATTRIBUTES

Prelude XL Max 15/16" Suspension System

- Supports point loads up to 347 lbs. using 3/8" threaded rod and integrated hanging clips to provide:
 - Flexible and reconfigurable overhead cable tray and electrical distribution to meet client needs without a separate strut channel system
 - Eliminates unsightly threaded rod penetrations through the ceiling plane for improved access and aesthetics
 - Reduced ceiling penetrations help minimize unwanted air infiltration
- Suspension system meets ASTM C635, ASTM C636, ASTM E580, ICC-ES AC156 with Seismic D, E, F available
- Custom colors available to coordinate with Ultima® Create!™ ceiling panels
- 30-Year Limited System Warranty

TYPICAL APPLICATIONS

- Data Centers

For custom layout information and technical guidelines, contact TechLineSM at 1 877 ARMSTRONG and select prompts 1-2-3.

VISUAL SELECTION

PERFORMANCE

PACKAGING

Item No.	Face Profile	Description	Dimensions (Inches)	Hanger Spacing* Lbs./Lin. Ft.	Fire Guard™	Seismic Category	Pcs./ Ctn.	Lin. Ft./ Ctn.
Prelude XL Max				4 Ft.	Dots represent high level of performance.			
<input type="checkbox"/> 730145	15/16"	12' HD Main Beam	144 x 15/16 x 2.44"	40.17	–	•	10	120
<input type="checkbox"/> XL7345	15/16"	4' Cross Tee	48 x 15/16 x 2.44"	40.17	–	•	30	120
<input type="checkbox"/> XL7325	15/16"	2' Cross Tee	24 x 15/16 x 2.44"	–	–	•	30	60
Molding								
<input type="checkbox"/> SWA9878HRC	7/8"	12' Structural Wall Angle	144 x 7/8 x 7/8"	–	–	•	12	144

*Simple Span

ACCESSORIES

IHC – Intersection Hanging Clip – Used to increase main beam to cross tee connection strength and carry the ceiling system with 3/8" threaded rod from structure.

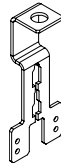

- IHC – 160 pcs
- FZHC – 50 pcs

PMLC – Prelude XL Max Load Connector – Used to support bus bars, cable trays, and other components with 3/8" threaded rod from the suspension system face.

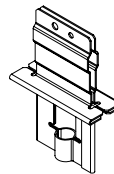

- PMLC – 100 pcs
- FZPMLC – 50 pcs

IJC – Intersection Joint Clip – Used at all cross tee-to-cross tee or main beam-to-cross tee connections not using an IHC Clip.

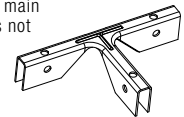

- IJC – 250 pcs
- FZIJC – 50 pcs

XTAC – Cross Tee Adapter Clip – Attaches cross tees or main beams to the structural wall molding when supporting heavy loads around the perimeter of the ceiling installation.

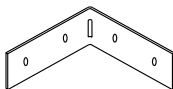

- XTAC – 100 pcs
- FZXTAC – 50 pcs

SHC – Supplemental Hanging Clip – Used to carry the ceiling system with 3/8" threaded rod from any location along the main beam when plenum obstructions prevent use of the IHC Clip.

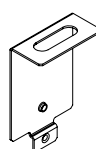

- SHC – 144 pcs
- FZSHC – 50 pcs

TLMBS – Top Lock Main Beam Splice Clip – Locks two main beams together for a secure connection.

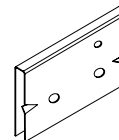

- 10 pcs (included with item 730145 Main Beam)
- FZTLMBS – 50 pcs

PMHDC – Prelude XL Max Hold Down Clip – Attaches to the top bulb of the Prelude XL Max suspension system to hold ceiling panels in place; helps to prevent ceiling panel movement.

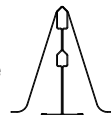

- PMHDC – 100 pcs
- FZPMHDC – 50 pcs

PRELUDE® XL MAX™

Exposed Tee System



Scan here to watch the installation video

PRELUDE XL MAX INSTALLATION OVERVIEW

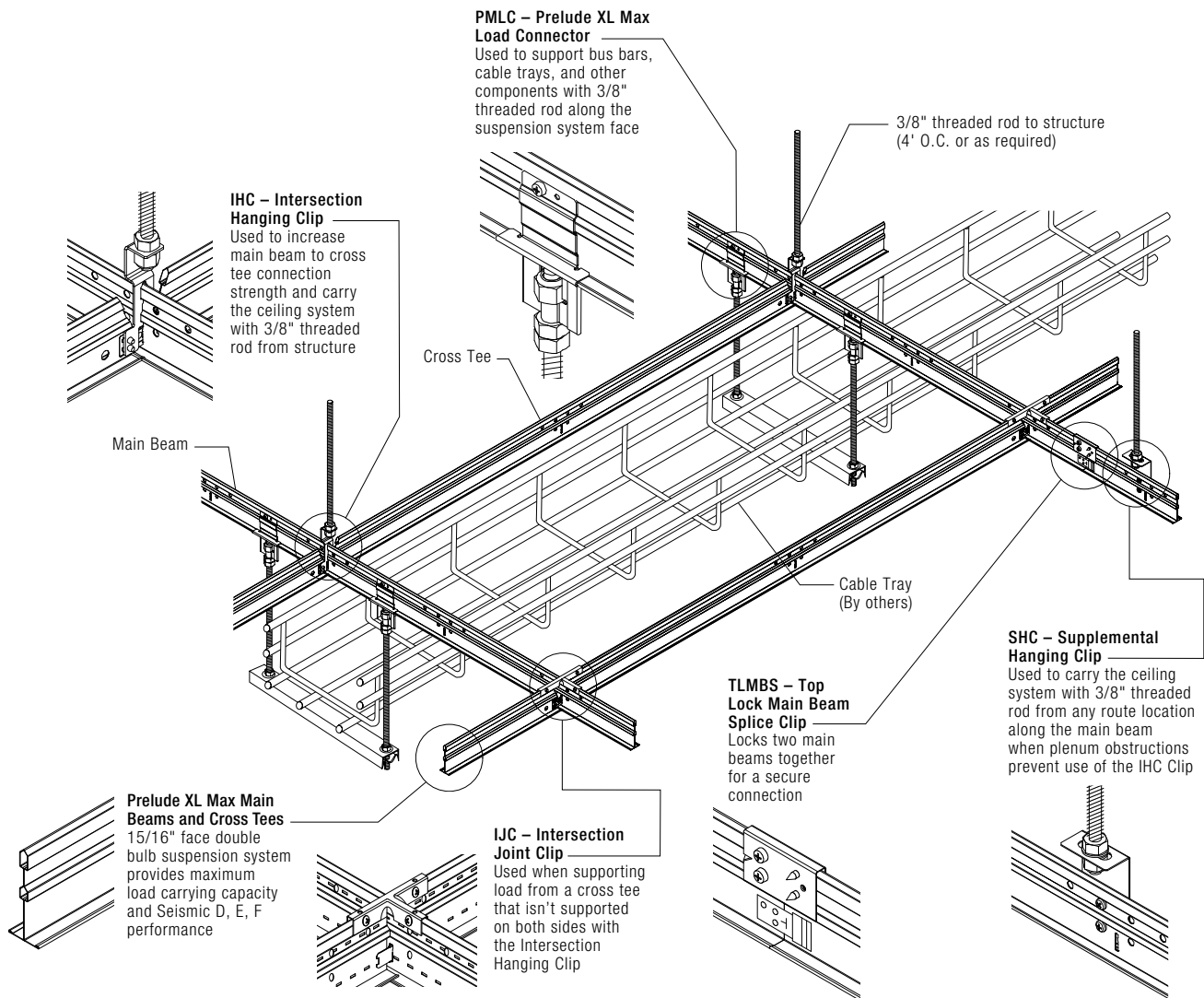

DETAILS

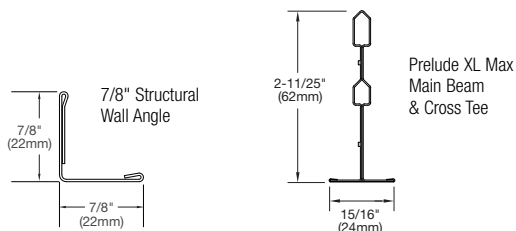

COLOR SELECTION

Due to printing limitations, shade may vary from actual product.



White is standard color for main beams and cross tees. All clips are unfinished.

Custom colors and finishes are available for main beams, cross tees, and load connector clips to coordinate with Create!™ ceiling panels and custom project colors.

Contact Armstrong Customer Service
1-877-276-7876

PHYSICAL DATA

Material
Hot dipped galvanized steel

Surface Finish
Baked polyester paint or powder coated

Face Dimension
15/16"

Profile
Exposed tee

Cross Tee/Main Beam Interface
Override

End Detail
Main Beam: Staked-on clip
Cross Tee: Staked-on clip

Duty Classification
Heavy-duty

TechLineSM / 1 877 ARMSTRONG
1 877 276 7876
armstrong.com/suspensionssystem
BPCS-4933-515

LEED® is a registered trademark of the U.S. Green Building Council
All other trademarks used herein are the property of AWI Licensing Company and/or its affiliates
© 2015 AWI Licensing Company • Printed in the United States of America

